

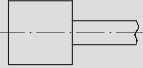

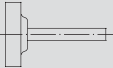







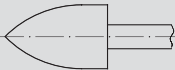

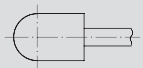
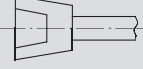
**A summary of available shapes**

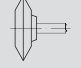
Shape	Type	Shape (Lukas)	Page
	Cylindrical, type 1	<b>ZY</b>	98
	Cylindrical, type 2	<b>ZY2</b>	105
	Cylindrical pointed nose	<b>WKS</b>	106
	Arch pointed nose	<b>SP</b>	107
	Spherical	<b>KU</b>	109
	Cylindrical round nose	<b>WR</b>	108
	Cup	<b>TO</b>	111
	Conical round nose	<b>KE</b>	111
	American shapes	<b>A</b>	113
	American shapes	<b>B</b>	114
	Miniature mounted points	<b>D</b>	114
	Taper sided grinding wheel	<b>SE4</b>	117
	Cup wheel for angle grinders	<b>SE6</b>	117
	Handstones	–	118
	Mounted points, assortments	–	119
	Power Tools	–	359

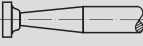
## Qualities

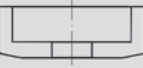
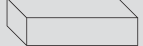
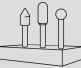
Grinding, Polishing  
(bonded)

### EKR

★★☆



aluminium oxide pink

### EKWbr

★★☆



aluminium oxide white,  
type brown



## General Information

<b>Properties of workpiece material:</b>	Mounted points in various qualities are needed to cover the wide spectrum of the numerous steel types and their resulting workpieces.	
<b>Industries</b>	<ul style="list-style-type: none"> <li>• Machine tools</li> <li>• Automotive</li> <li>• Toolbuilding</li> </ul>	<ul style="list-style-type: none"> <li>• Vessel manufacturers</li> <li>• Shipyards</li> <li>• and many more</li> </ul>
<b>Examples of application:</b>	<ul style="list-style-type: none"> <li>• General rough grinding</li> <li>• Fettingling</li> <li>• Rough grinding of weld seams</li> </ul>	<ul style="list-style-type: none"> <li>• Finish grinding of weld seams</li> <li>• Deburring</li> </ul>
<b>LUKAS grinding tools:</b>	The wide selection of LUKAS-grinding tools incorporates numerous shapes, sizes and qualities. You will find the correct tool from our standard range to solve most grinding problems irrespective of material to be ground, type of machine or any other influencing factors. These mounted points are designed for high stock removal and long tool life.	

Qualities



**RKD**

★★☆

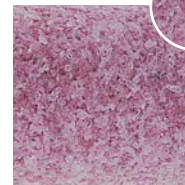

mixture aluminium oxide deep red / aluminium oxide pink

**NK-BA-soft**

★★☆

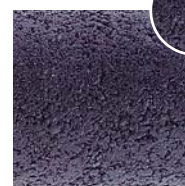

aluminium oxide resin bonded iron and sulphur free

Grinding, Polishing (bonded)

General Information

<b>Properties of workpiece material:</b>	Alloyed steels i.e., non-rusting steels are included in the materials which are difficult to machine. They tend to “smear” due to the nickel content, and as a result of poor heat dissipation cause overheating of the material within the grinding contact zone.		
<b>Industries</b>	<ul style="list-style-type: none"> <li>• Steel construction and fabrication (façades, handrails, sanitary equipment)</li> <li>• Vessel manufacturing</li> </ul>	<ul style="list-style-type: none"> <li>• Casings and panelling</li> <li>• Medical technology</li> <li>• Shipyards</li> </ul>	<ul style="list-style-type: none"> <li>• Food industry</li> <li>• and many more</li> </ul>
<b>Examples of application:</b>	<ul style="list-style-type: none"> <li>• Rough and finish grinding</li> <li>• Deburring</li> <li>• Fettingling</li> </ul>	<ul style="list-style-type: none"> <li>• Removing weld seams</li> <li>• Surface finishing</li> </ul>	
<b>LUKAS grinding tools:</b>	LUKAS has developed particular high performance qualities for alloyed steels distinguished by exceptional stock removal despite operating under difficult conditions. These tools contain no iron, no sulphur and no halogens; a chemical reaction (corrosion) of the workpiece material in the grinding contact zone is therefore generally avoided.		

## Qualities

Grinding, Polishing  
(bonded)

### NK Ba-hard

★★☆



aluminium oxide resin bonded

### MK

★★☆

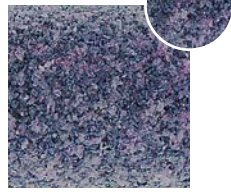

mixture aluminium oxide pink / aluminium oxide

### HK

★★☆



mixture aluminium oxide white / aluminium oxide



## General Information

<b>Properties of workpiece material:</b>	The characteristics of the various types of cast materials are normally determined by their carbon content, and the way in which the carbon is removed from the material structure. Cast components are generally “rough” machined. The skin contains inclusions of sand from the casting process; large burrs, runners and risers, holes and cracks must all be removed by grinding. These areas to be ground are often somewhat inaccessible.
<b>Industries</b>	<ul style="list-style-type: none"> <li>• Manufacturers of cast components i.e., engine blocks, gear box casings, cylinder heads, frames, stands, machine slides, gears, crankshafts, pump and turbine housings, machine tool components</li> <li>• and many more</li> </ul>
<b>Examples of application:</b>	<ul style="list-style-type: none"> <li>• Deburring</li> <li>• Fettleing</li> <li>• Polishing</li> <li>• Finish grinding of repair welds</li> <li>• Removing holes and cracks</li> </ul>
<b>LUKAS grinding tools:</b>	The LUKAS mounted points specifically formulated to grind cast materials contain special grain combinations and tough bonding systems; such qualities give optimum performance for the applications mentioned above. The aggressiveness of the abrasive grain and the smooth running of the mounted points allow for an ergonomic method of machining requiring minimum force. Mounted points with specially extended shafts are also available on request.

## Qualities



### NDW

★★★



mixture aluminium oxide, aluminium oxide dark red and monocrystal aluminium oxide white

### CERAMIC

★★★

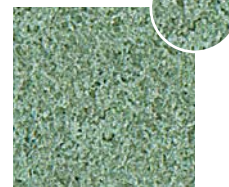

Mixture of ceramic grain and monocrystal aluminium oxide

### EKbr

★★☆



aluminium oxide pink, type brown

### EKW

★★☆



aluminium oxide white

## General Information

<b>Properties of workpiece material:</b>	Precision is a major factor in the tool and mould industry. Tool steels are selected with the appropriate hardness and toughness to suit the application; special mounted point qualities are therefore essential to achieve the tight tolerances required.		
<b>Industries</b>	<ul style="list-style-type: none"> <li>• Toolmakers</li> <li>• Pattern shops</li> <li>• Mould manufacturers</li> </ul>	<ul style="list-style-type: none"> <li>• Aerospace</li> </ul>	
<b>Examples of application:</b>	<ul style="list-style-type: none"> <li>• Re-grinding</li> <li>• Groove grinding</li> <li>• Fine deburring</li> </ul>	<ul style="list-style-type: none"> <li>• Finish grinding</li> <li>• Lapping</li> <li>• Coordinate grinding</li> </ul>	<ul style="list-style-type: none"> <li>• Ball bearing grinding</li> <li>• Turbine blades</li> </ul>
<b>LUKAS grinding tools:</b>	LUKAS mounted points for tool and mould-making are extremely dimensionally stable and can cut even the hardest materials. Ceramic abrasive grit is extremely friable due to its microcrystal structure. This makes it self-sharpening. Therefore, materials which are difficult to cut (e.g. nickel-based alloys) can be machined without any problems. Moreover, the use of special grain qualities ensures a long service life. Moreover, the use of special grain qualities ensures a long service life.		

## Qualities

Grinding, Polishing  
(bonded)

### SIC-ALU

\*\*\*



silicon carbide green



## General Information

<b>Properties of workpiece material:</b>	Aluminium and its associated alloys have many varied and positive characteristics making it the second most widely used metal after steel. Aluminium has only 1/3 the density of steel. The purer the metal, the weaker it becomes but allows for better shape forming. Unsuitable mounted point qualities are often used which "load".		
<b>Industries</b>	<ul style="list-style-type: none"> <li>• Transport (railways, ships, automotive, aerospace)</li> <li>• Metal construction (bridges, cranes, silos)</li> </ul>	<ul style="list-style-type: none"> <li>• Apparatus engineering</li> <li>• Chemical industry (vessels, pumps, pipes)</li> </ul>	<ul style="list-style-type: none"> <li>• Engine, transmission parts</li> <li>• and many more</li> </ul>
<b>Examples of application:</b>	<ul style="list-style-type: none"> <li>• Deburring</li> <li>• Fetting</li> </ul>	<ul style="list-style-type: none"> <li>• Re-working</li> <li>• Surface finishing</li> </ul>	
<b>LUKAS grinding tools:</b>	The LUKAS mounted points in the quality SIC – ALU have been developed solely for this application. Due to a special structure, maximum tool life is achieved whilst preventing "loading" of material within the pores. The self-dressing effect is aided by the use of a special impregnation.		

## Qualities



**HOK**

★★☆



mixture spherical  
aluminium oxide grain

## General Information

<b>Properties of workpiece material:</b>	Materials such as rubber or plastic are very elastic and have a very low melting point. They flex and generate heat; this often results in a bad odour and loading.	
<b>Industries</b>	<ul style="list-style-type: none"> <li>• Machining rubber</li> <li>• Machining plastic</li> </ul>	
<b>Examples of application:</b>	<ul style="list-style-type: none"> <li>• Tyre repair and re-vulcanizing</li> <li>• Repair of conveyor belts</li> </ul>	<ul style="list-style-type: none"> <li>• Preparation of various areas for adhesion</li> <li>• Deburring of rubber or plastic components</li> </ul>
<b>LUKAS grinding tools:</b>	LUKAS abrasive tools for the machining of rubber and plastic contain a special spherical grain (HOK) in a very open ceramic structure. This abrasive media creates permanent small razor-sharp cutting edges which pluck-out the material from the surface. Consequently, these tools are ideally suited for the machining applications as illustrated.	







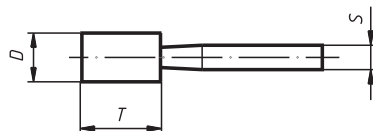

**Shape ZY, Cylinder, Type 1 (according to DIN 69170)**

Ordering example: A200000104302

Further dimensions, qualities and shank lengths on request.



Grinding, Polishing (bonded)



**PG 3**

Product number	Description	Quality	D mm	T mm	S mm	recommended for Information on page 438												
A200000810608	ZY 0810.06	EKW 80 L V1	8	10	6 x 40			③						⑦		⑨	■	20
A200000810647	ZY 0810.06	RKD 80 QU V21	8	10	6 x 40		②	③	④								■	20
A200000816302	ZY 0816.03	EKR 60 N V4	8	16	3 x 30	①	②	③									■	20
A200000816312	ZY 0816.03	EKWBR 60 O/P V7	8	16	3 x 30	①	②										■	20
A200000816347	ZY 0816.03	RKD 80 QU V21	8	16	3 x 30		②	③	④								■	20
A200000816602	ZY 0816.06	EKR 60 N V4	8	16	6 x 40	①	②	③									■	20
A200000816647	ZY 0816.06	RKD 80 QU V21	8	16	6 x 40		②	③	④								■	20
A200000820602	ZY 0820.06	EKR 60 N V4	8	20	6 x 40	①	②	③									■	20
A200001010302	ZY 1010.03	EKR 60 N V4	10	10	3 x 30	①	②	③									■	20
A2000010103020001	ZY 1010.03	EKR 60/80 QU V4	10	10	3 x 30	①	②	③									■	20
A200001010312	ZY 1010.03	EKWBR. 60 O/P V7	10	10	3 x 30	①	②										■	20
A200001010347	ZY 1010.03	RKD 80 P V21	10	10	3 x 30		②	③	④								■	20
A200001010602	ZY 1010.06	EKR 60 N V4	10	10	6 x 40	①	②	③									■	20
A200001010608	ZY 1010.06	EKW 60 L V1	10	10	6 x 40			③					⑦		⑨	■	20	
A200001010647	ZY 1010.06	RKD 80 P V21	10	10	6 x 40		②	③	④								■	20
A200001013302	ZY 1013.03	EKR 60 N V4	10	13	3 x 30	①	②	③									■	20
A200001013312	ZY 1013.03	EKWBR 60 O/P V7	10	13	3 x 30	①	②										■	20
A200001013602	ZY 1013.06	EKR 60 N V4	10	13	6 x 40	①	②	③									■	20
A200001020602	ZY 1020.06	EKR 60 N V4	10	20	6 x 40	①	②	③									■	20
A2000010206020001	ZY 1020.06	EKR 46 QU V4	10	20	6 x 40	①	②	③									■	20
A200001020612	ZY 1020.06	EKWBR 60 O/P V7	10	20	6 x 40	①	②										■	20
A200001020616	ZY 1020.06	MK 46 N V10	10	20	6 x 40		②		④	⑤							■	20
A200001020627	ZY 1020.06	NK 46 QU BA hard	10	20	6 x 40		②	③		⑤							■	20
A200001032602	ZY 1032.06	EKR 60 N V4	10	32	6 x 40	①	②	③									■	20
A2000010326020001	ZY 1032.06	EKR 46 QU V4	10	32	6 x 40	①	②	③									■	20
A200001032612	ZY 1032.06	EKWBR 60 O/P V7	10	32	6 x 40	①	②										■	20
A200001032627	ZY 1032.06	NK 46 QU BA hard	10	32	6 x 40		②	③		⑤							■	20
A200001040602	ZY 1040.06	EKR 60 N V4	10	40	6 x 40	①	②	③									■	20
A200001040627	ZY 1040.06	NK 46 QU BA hard	10	40	6 x 40		②	③		⑤							■	20
A200001313302	ZY 1313.03	EKR 46 N V4	13	13	3 x 30	①	②	③									■	20
A200001313312	ZY 1313.03	EKWBR 60 O/P V7	13	13	3 x 30	①	②										■	20
A200001313347	ZY 1313.03	RKD 60 P (6) V21	13	13	3 x 30		②	③	④								■	20
A200001313602	ZY 1313.06	EKR 46 N V4	13	13	6 x 40	①	②	③									■	20
A200001313647	ZY 1313.06	RKD 60 P (6) V21	13	13	6 x 40		②	③	④								■	20
A200001320602	ZY 1320.06	EKR 46 N V4	13	20	6 x 40	①	②	③									■	20
A2000013206020001	ZY 1320.06	EKR 46 QU V4	13	20	6 x 40	①	②	③									■	20
A200001320612	ZY 1320.06	EKWBR 60 O/P V7	13	20	6 x 40	①	②										■	20

Shape ZY, Cylinder, Type 1 (according to DIN 69170)

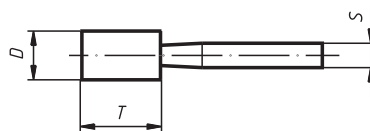

Grinding, Polishing (bonded)



Ordering example: A20000104302

Further dimensions, qualities and shank lengths on request.



PG 3

Product number	Description	Quality	D mm	T mm	S mm	recommended for Information on page 438										PG 3		
A200001320616	ZY 1320.06	MK 46 N V10	13	20	6 x 40		②		④	⑤							■	20
A200001320627	ZY 1320.06	NK 46 QU BA hard	13	20	6 x 40		②	③		⑤							■	20
A200001325602	ZY 1325.06	EKR 46 N V4	13	25	6 x 40	①	②	③									■	20
A200001325647	ZY 1325.06	RKD 60 QU V21	13	25	6 x 40		②	③	④								■	20
A200001332602	ZY 1332.06	EKR 46 N V4	13	32	6 x 40	①	②	③									■	20
A200001332627	ZY 1332.06	NK 46 QU BA hard	13	32	6 x 40		②	③		⑤							■	20
A200001332627W	ZY 1332.06	NK 24 N BA soft	13	32	6 x 40		②	③	④		⑥						■	20
A200001616602	ZY 1616.06	EKR 46 N V4	16	16	6 x 40	①	②	③									■	20
A200001616647	ZY 1616.06	RKD 36 O (6) V21	16	16	6 x 40		②	③	④								■	20
A200001620602	ZY 1620.06	EKR 46 N V4	16	20	6 x 40	①	②	③									■	20
A200001620612	ZY 1620.06	EKWBR 46 O/P V7	16	20	6 x 40	①	②										■	20
A200001620627	ZY 1620.06	NK 24 QU BA hard	16	20	6 x 40		②	③		⑤							■	20
A200001632602	ZY 1632.06	EKR 46 N V4	16	32	6 x 40	①	②	③									■	20
A200001632612	ZY 1632.06	EKWBR 46 O/P V7	16	32	6 x 40	①	②										■	20
A200001632616	ZY 1632.06	MK 36 N V10	16	32	6 x 40		②		④	⑤							■	20
A200001632627	ZY 1632.06	NK 24 QU BA. hard	16	32	6 x 40		②	③		⑤							■	20
A200001632627W	ZY 1632.06	NK 24 N BA. soft	16	32	6 x 40		②	③	④		⑥						■	20
A200001632633	ZY 1632.06	HK 30 N V13	16	32	6 x 40				④	⑤							■	20
A200001632647	ZY 1632.06	RKD 36 O (6) V21	16	32	6 x 40		②	③	④								■	20
A200001640602	ZY 1640.06	EKR 46 N V4	16	40	6 x 40	①	②	③									■	20
A200001640616	ZY 1640.06	MK 36 N V10	16	40	6 x 40		②		④	⑤							■	20
A200001640627	ZY 1640.06	NK 24 QU BA hard	16	40	6 x 40		②	③		⑤							■	20
A200002013602	ZY 2013.06	EKR 36 N V4	20	13	6 x 40	①	②	③									■	20
A200002020602	ZY 2020.06	EKR 36 N V4	20	20	6 x 40	①	②	③									■	20
A200002020608	ZY 2020.06	EKW 60 L V1	20	20	6 x 40			③			⑦		⑨				■	20
A200002020616	ZY 2020.06	MK 36 N V10	20	20	6 x 40		②		④	⑤							■	20
A200002020627	ZY 2020.06	NK 24 QU BA hard	20	20	6 x 40		②	③		⑤							■	20
A200002020647	ZY 2020.06	RKD 36 O (6) V21	20	20	6 x 40		②	③	④								■	20
A200002025602	ZY 2025.06	EKR 36 N V4	20	25	6 x 40	①	②	③									■	20
A200002025647	ZY 2025.06	RKD 36 O (6) V21	20	25	6 x 40		②	③	④								■	20
A202202025626	ZY 2025.06	HOK 0-3 V9	20	25	6 x 40								⑧				■	20
A200002032602	ZY 2032.06	EKR 36 N V4	20	32	6 x 40	①	②	③									■	20
A2000020326020001	ZY 2032.06	EKR 30/36 QU (7) V21	20	32	6 x 40	①	②	③									■	20
A200002032616	ZY 2032.06	MK 36 N V10	20	32	6 x 40		②		④	⑤							■	20
A200002032627	ZY 2032.06	NK 24 QU BA hard	20	32	6 x 40		②	③		⑤							■	20
A200002032633	ZY 2032.06	HK 30 N V13	20	32	6 x 40				④	⑤							■	20
A200002032647	ZY 2032.06	RKD 36 O (6) V21	20	32	6 x 40		②	③	④								■	20

Shape ZY, Cylinder, Type 1 (according to DIN 69170)

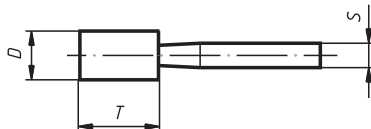

Ordering example: A20000104302

Further dimensions, qualities and shank lengths on request.



Grinding, Polishing (bonded)



PG 3

Product number	Description	Quality	D mm	T mm	S mm	recommended for Information on page 438		
A200002040602	ZY 2040.06	EKR 36 N V4	20	40	6 x 40	① ② ③	■	20
A200002040612	ZY 2040.06	EKWBR 46 O/P V7	20	40	6 x 40	① ②	■	20
A200002040616	ZY 2040.06	MK 36 N V10	20	40	6 x 40	② ④ ⑤	■	20
A200002040627	ZY 2040.06	NK 24 QU BA hard	20	40	6 x 40	② ③ ⑤	■	20
A200002040627W	ZY 2040.06	NK 24 N BA. soft	20	40	6 x 40	② ③ ④ ⑥	■	20
A200002040633	ZY 2040.06	HK 30 N V13	20	40	6 x 40	④ ⑤	■	20
A200002040647	ZY 2040.06	RKD 36 O (6) V21	20	40	6 x 40	② ③ ④	■	20
A200002040827	ZY 2040.08	NK 24 QU BA hard	20	40	8 x 40	② ③ ⑤	■	20
A200002040827W	ZY 2040.08	NK 24 N BA. soft	20	40	8 x 40	② ③ ④ ⑥	■	20
A200002040833	ZY 2040.08	HK 30 N V13	20	40	8 x 40	④ ⑤	■	20
A200002520602	ZY 2520.06	EKR 36 N V4	25	20	6 x 40	① ② ③	■	20
A200002525602	ZY 2525.06	EKR 36 N V4	25	25	6 x 40	① ② ③	■	20
A200002525627	ZY 2525.06	NK 24 QU BA hard	25	25	6 x 40	② ③ ⑤	■	20
A200002525647	ZY 2525.06	RKD 30 O (6) V21	25	25	6 x 40	② ③ ④	■	20
A200002532602	ZY 2532.06	EKR 36 N V4	25	32	6 x 40	① ② ③	■	20
A200002532616	ZY 2532.06	MK 36 N V10	25	32	6 x 40	② ④ ⑤	■	20
A200002532627	ZY 2532.06	NK 24 QU BA hard	25	32	6 x 40	② ③ ⑤	■	20
A200002532627W	ZY 2532.06	NK 24 N BA. soft	25	32	6 x 40	② ③ ④ ⑥	■	20
A200002532633	ZY 2532.06	HK 30 N V13	25	32	6 x 40	④ ⑤	■	20
A200002532647	ZY 2532.06	RKD 30 O (6) V21	25	32	6 x 40	② ③ ④	■	20
A200003220602	ZY 3220.06	EKR 30 N V4	32	20	6 x 40	① ② ③	■	20
A200003220616	ZY 3220.06	MK 36 N V10	32	20	6 x 40	② ④ ⑤	■	20
A200003220627	ZY 3220.06	NK 24 QU BA hard	32	20	6 x 40	② ③ ⑤	■	20
A200003232602	ZY 3232.06	EKR 30 N V4	32	32	6 x 40	① ② ③	■	20
A2000032326020001	ZY 3232.06	EKR 30/36 QU (7) V21	32	32	6 x 40	① ② ③	■	20
A200003232612	ZY 3232.06	EKWBR 46 O/P V7	32	32	6 x 40	① ②	■	20
A200003232616	ZY 3232.06	MK 36 N V10	32	32	6 x 40	② ④ ⑤	■	20
A200003232627	ZY 3232.06	NK 24 QU BA hard	32	32	6 x 40	② ③ ⑤	■	20
A200003232627W	ZY 3232.06	NK 24 N BA. soft	32	32	6 x 40	② ③ ④ ⑥	■	20
A200003232647	ZY 3232.06	RKD 30 O (6) V21	32	32	6 x 40	② ③ ④	■	20
A200003240602	ZY 3240.06	EKR 30 N V4	32	40	6 x 40	① ② ③	■	20
A200003240616	ZY 3240.06	MK 36 N V10	32	40	6 x 40	② ④ ⑤	■	20
A200003240647	ZY 3240.06	RKD 30 O (6) V21	32	40	6 x 40	② ③ ④	■	20
A200003250827	ZY 3250.08	NK 24 O BA.64	32	50	8 x 40	② ③ ⑤	■	20
A200004020602	ZY 4020.06	EKR 30 N V4	40	20	6 x 40	① ② ③	■	20
A200004020616	ZY 4020.06	MK 36 N V10	40	20	6 x 40	② ④ ⑤	■	20
A200004020627	ZY 4020.06	NK 24 QU BA hard	40	20	6 x 40	② ③ ⑤	■	20

Shape ZY, Cylinder, Type 1 (according to DIN 69170)



Grinding, Polishing  
(bonded)

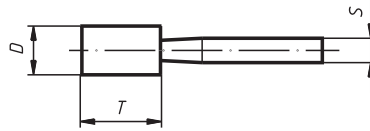

Ordering example: A200000104302

Further dimensions, qualities and shank lengths on request.

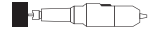

PG 3

Product number	Description	Quality	D mm	T mm	S mm	recommended for Information on page 438													
A200004020627W	ZY 4020.06	NK 24 N BA. soft	40	20	6 x 40	② ③ ④ ⑥												■	20
A200004020633	ZY 4020.06	HK 30 N V13	40	20	6 x 40				④ ⑤									■	20
A200004020647	ZY 4020.06	RKD 24 O (6) V21	40	20	6 x 40	② ③ ④												■	20
A200004020827	ZY 4020.08	NK 24 QU BA hard	40	20	8 x 40	② ③			⑤									■	20
A200004020827W	ZY 4020.08	NK 24 N BA. soft	40	20	8 x 40	② ③ ④ ⑥												■	20
A200004020833	ZY 4020.08	HK 30 N V13	40	20	8 x 40				④ ⑤									■	20
A200004020847	ZY 4020.08	RKD 24 O (6) V21	40	20	8 x 40	② ③ ④												■	20
A202204020626	ZY 4020.06	HOK 0-3 V9	40	20	6 x 40												⑧	■	20
A200004025833	ZY 4025.08	HK 24/30 P V4	40	25	8 x 40				④ ⑤									■	20
A200004040602	ZY 4040.06	EKR 30 N V4	40	40	6 x 40	① ② ③												■	20
A200004040647	ZY 4040.06	RKD 24 O (6) V21	40	40	6 x 40	② ③ ④												■	20
A200004040816	ZY 4040.08	MK 36 N V10	40	40	8 x 40	②			④ ⑤									■	20
A200004040827	ZY 4040.08	NK 24 QU BA hard	40	40	8 x 40	② ③			⑤									■	20
A200004040847	ZY 4040.08	RKD 24 O (6) V21	40	40	8 x 40	② ③ ④												■	20
A200005013827	ZY 5013.08	NK 24 QU BA hard	50	13	8 x 40	② ③			⑤									■	20
A200005020602	ZY 5020.06	EKR 30 N V4	50	20	6 x 40	① ② ③												■	20
A200005020627	ZY 5020.06	NK 24 QU BA hard	50	20	6 x 40	② ③			⑤									■	20
A200005020627W	ZY 5020.06	NK 24 N BA. soft	50	20	6 x 40	② ③ ④ ⑥												■	20
A200005020647	ZY 5020.06	RKD 24 O (6) V21	50	20	6 x 40	② ③ ④												■	20
A200005020827	ZY 5020.08	NK 24 QU BA hard	50	20	8 x 40	② ③			⑤									■	20
A200005025616	ZY 5025.06	MK 30 N V10	50	25	6 x 40	②			④ ⑤									■	20
A200005025827	ZY 5025.08	NK 24 QU BA hard	50	25	8 x 40	② ③			⑤									■	20

Shape ZY, Cylinder, Type 2 (according to DIN 69170)

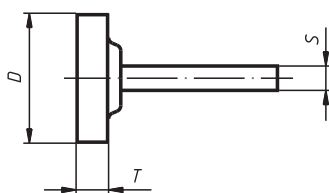

Ordering example: A201301303377

Further dimensions, qualities and shank lengths on request.



PG 3

Product number	Description	Quality	D mm	T mm	S mm	recommended for Information on page 438		
A201301303377	ZY2 1303.03	CERAMIC 80 LV118	13	3	3 x 30	② ③ ④ ⑦	■	20

Shape ZY, Cylinder, Type 2 (according to DIN 69170)

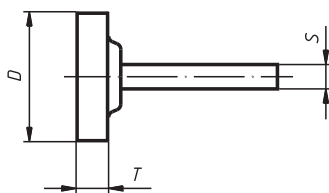

Ordering example: A201301303302

Further dimensions, qualities and shank lengths on request.



PG 3

Product number	Description	Quality	D mm	T mm	S mm	recommended for Information on page 438		
A201301303302	ZY2 1303.03	EKR 80 NV4	13	3	3 x 30	① ② ③	■	20
A201301303312	ZY2 1303.03	EKWBR 80 O/P V7	13	3	3 x 30	① ②	■	20
A201301303347	ZY2 1303.03	RKD 80 QU V21	13	3	3 x 30	② ③ ④	■	20
A201301303602	ZY2 1303.06	EKR 80 NV4	13	3	6 x 40	① ② ③	■	20
A201301604302	ZY2 1604.03	EKR 60 NV4	16	4	3 x 30	① ② ③	■	20
A201301604312	ZY2 1604.03	EKWBR 60 O/P V7	16	4	3 x 30	① ②	■	20
A201301604347	ZY2 1604.03	RKD 80 QU V21	16	4	3 x 30	② ③ ④	■	20
A201301604602	ZY2 1604.06	EKR 60 NV4	16	4	6 x 40	① ② ③	■	20
A201302006302	ZY2 2006.03	EKR 60 NV4	20	6	3 x 30	① ② ③	■	20
A201302006312	ZY2 2006.03	EKWBR 60 O/P V7	20	6	3 x 30	① ②	■	20
A201302006602	ZY2 2006.06	EKR 60 NV4	20	6	6 x 40	① ② ③	■	20
A2013020066020001	ZY2 2006.06	EKR 46 QU V4	20	6	6 x 40	① ② ③	■	20
A201302506602	ZY2 2506.06	EKR 60 NV4	25	6	6 x 40	① ② ③	■	20
A201302506627	ZY2 2506.06	NK 24 N BA. soft	25	6	6 x 40	② ③ ④ ⑥	■	20
A201302510602	ZY2 2510.06	EKR 36 NV4	25	10	6 x 40	① ② ③	■	20
A201302510627	ZY2 2510.06	NK 24 QU BA. hard	25	10	6 x 40	② ③ ⑤	■	20
A201303208602	ZY2 3208.06	EKR 46 NV4	32	8	6 x 40	① ② ③	■	20
A201303208627	ZY2 3208.06	NK 24 QU BA. hard	32	8	6 x 40	② ③ ⑤	■	20
A201303208647	ZY2 3208.06	RKD 36 O (6) V21	32	8	6 x 40	② ③ ④	■	20

Shape ZY, Cylinder, Type 2 (according to DIN 69170)



Grinding, Polishing  
(bonded)

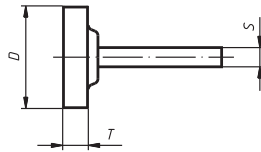

Ordering example: A201301303302

Further dimensions, qualities and shank lengths on request.

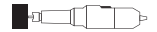

PG 3

Product number	Description	Quality	D mm	T mm	S mm	recommended for Information on page 438		
A201304006627	ZY2 4006.06	NK 24 N BA. soft	40	10	6 x 40	② ③ ④ ⑥	■	20
A201304010602	ZY2 4010.06	EKR 30 N V4	40	10	6 x 40	① ② ③	■	20
A201304010616	ZY2 4010.06	MK 36 N V10	40	10	6 x 40	② ④ ⑤	■	20
A201304010627	ZY2 4010.06	NK 24 QU BA. hard	40	10	6 x 40	② ③ ⑤	■	20
A201304010627W	ZY2 4010.06	NK 24 N BA. soft	40	10	6 x 40	② ③ ④ ⑥	■	20
A201304010647	ZY2 4010.06	RKD 30 O (6) V21	40	10	6 x 40	② ③ ④	■	20
A201305004627	ZY2 5004.06	NK 24 QU BA. hard	50	4	6 x 40	② ③ ⑤	■	20
A201305004627W	ZY2 5004.06	NK 24 N BA. soft	50	4	6 x 40	② ③ ④ ⑥	■	20
A201305006627	ZY2 5006.06	NK 24 QU BA. hard	50	6	6 x 40	② ③ ⑤	■	20
A201305006627W	ZY2 5006.06	NK 24 N BA. soft	50	6	6 x 40	② ③ ④ ⑥	■	20
A201305010602	ZY2 5010.06	EKR 30 N V4	50	10	6 x 40	① ② ③	■	20
A201305010627	ZY2 5010.06	NK 24 QU BA. hard	50	10	6 x 40	② ③ ⑤	■	20
A201305010627W	ZY2 5010.06	NK 24 N BA. soft	50	10	6 x 40	② ③ ④ ⑥	■	20
A201305010633	ZY2 5010.06	HK 30 N V13	50	10	6 x 40	④ ⑤	■	20
A201305010827	ZY2 5010.08	NK 24 QU BA. hard	50	10	8 x 40	② ③ ⑤	■	20
A201305010827W	ZY2 5010.08	NK 24 N BA. soft	50	10	8 x 40	② ③ ④ ⑥	■	20
A201306510827	ZY2 6510.08	NK 24 P BA.15	65	10	8 x 40	② ③ ⑤	■	20

Shape WKS, Cylindrical pointed nose

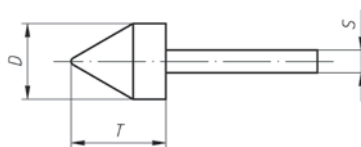

Ordering example: A200402025602

Further dimensions, qualities and shank lengths on request.



PG 3

Product number	Description	Quality	D mm	T mm	S mm	recommended for Information on page 438		
A200402025602	WKS 2025.06	EKR 60 N V4	20	25	6 x 40	① ② ③	■	20



Shape SP, Arch pointed nose (according to DIN 69170)

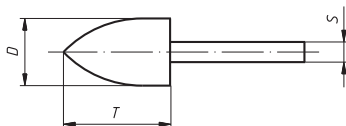

Ordering example: A200200306377

Further dimensions, qualities and shank lengths on request.



Grinding, Polishing (bonded)



PG 3

Product number	Description	Quality	D mm	T mm	S mm	recommended for										PG 3	Information on page 438	Icon		
						②	③	④	⑤	⑥	⑦	⑧	⑨	⑩	⑪				⑫	
A200200306377	SP 0306.03	CERAMIC 80 L V118	3	6	3 x 30		②	③	④						⑦				■	20
A200200510377	SP 0510.03	CERAMIC 80 L V118	5	10	3 x 30		②	③	④						⑦				■	20
A200200816377	SP 0816.03	CERAMIC 80 L V118	8	16	3 x 30		②	③	④						⑦				■	20
A200201320677	SP 1320.06	CERAMIC 80 L V118	13	20	6 x 40		②	③	④						⑦				■	20

Shape SP, Pointed nose (according to DIN 69170)

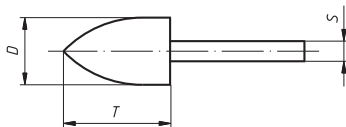

Ordering example: A200200510353

Further dimensions, qualities and shank lengths on request.



PG 3

Product number	Description	Quality	D mm	T mm	S mm	recommended for										PG 3	Information on page 438	Icon		
						②	③	④	⑤	⑥	⑦	⑧	⑨	⑩	⑪				⑫	
A200200510353	SP 0510.03	NDW 100 QU V115	5	10	3 x 50		②	③											■	20
A2002005103530001	SP 0510.03	NDW 100 QU V115	5	10	3 x 30		②	③											■	20
A200200810353	SP 0810.03	NDW 100 QU V115	8	10	3 x 50		②	③											■	20
A2002008103530001	SP 0810.03	NDW 100 QU V115	8	10	3 x 30		②	③											■	20

Shape SP, Pointed nose (according to DIN 69170)



Grinding, Polishing  
(bonded)

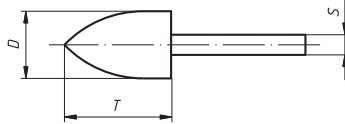

Ordering example: A200200306302

Further dimensions, qualities and shank lengths on request.

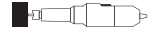

PG 3

Product number	Description	Quality	D mm	T mm	S mm	recommended for Information on page 438		
A200200306302	SP 0306.03	EKR 100 N V4	3	6	3 x 30	① ② ③	■	20
A200200306347	SP 0306.03	RKD 120 QU V21	3	6	3 x 30	② ③ ④	■	20
A200200510302	SP 0510.03	EKR 80 N V4	5	10	3 x 30	① ② ③	■	20
A200200510347	SP 0510.03	RKD 100 QU V21	5	10	3 x 30	② ③ ④	■	20
A200200510602	SP 0510.06	EKR 80 N V4	5	10	6 x 40	① ② ③	■	20
A200200816302	SP 0816.03	EKR 60 N V4	8	16	3 x 30	① ② ③	■	20
A200200816347	SP 0816.03	RKD 80 QU V21	8	16	3 x 30	② ③ ④	■	20
A200200816602	SP 0816.06	EKR 60 N V4	8	16	6 x 40	① ② ③	■	20
A200201020602	SP 1020.06	EKR 60 N V4	10	20	6 x 40	① ② ③	■	20
A200201320602	SP 1320.06	EKR 46 N V4	13	20	6 x 40	① ② ③	■	20
A200202032602	SP 2032.06	EKR 36 N V4	20	32	6 x 40	② ③ ④	■	20

Shape WR, Cylindrical round nose (according to DIN 69170)

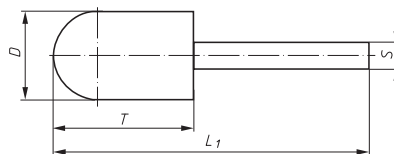

Ordering example: A201401013353

Further dimensions, qualities and shank lengths on request.

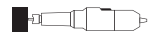

PG 3

Product number	Description	Quality	D mm	T mm	S mm	recommended for Information on page 438		
A2014010133530001	WR 1013.03	NDW 100 QU V115	10	13	3 x 30	② ③	■	20
A201401013353	WR 1013.03	NDW 100 QU V115	10	13	3 x 50	② ③	■	20

Shape KU, Spherical (according to DIN 69170)

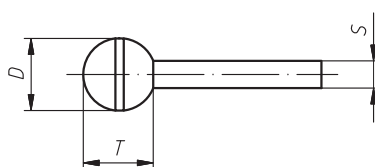

Ordering example: A201100404377

Further dimensions, qualities and shank lengths on request.



Grinding, Polishing (bonded)



PG 3

Product number	Description	Quality	D mm	T mm	S mm	recommended for										Information on page 438	PG 3	Icon		
						②	③	④	⑤	⑥	⑦	⑧	⑨	⑩	⑪				⑫	
A201100404377	KU 0404.03	CERAMIC 80 L V118	4	4	3 x 30		②	③	④						⑦				■	20
A201100606377	KU 0606.03	CERAMIC 80 L V118	6	6	3 x 30		②	③	④						⑦				■	20
A201101010677	KU 1010.06	CERAMIC 46 L V118	10	10	6 x 40		②	③	④						⑦				■	20
A201101313677	KU 1313.06	CERAMIC 46 L V118	13	13	6 x 40		②	③	④						⑦				■	20

Shape KU, Spherical (according to NDW 100 QU V115)

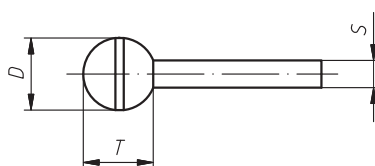

Ordering example: A201100404353

Further dimensions, qualities and shank lengths on request.



PG 3

Product number	Description	Quality	D mm	T mm	S mm	recommended for										Information on page 438	PG 3	Icon		
						②	③	④	⑤	⑥	⑦	⑧	⑨	⑩	⑪				⑫	
A2011004043530001	KU 0404.03	NDW 100 QU V115	4	4	3 x 30		②	③											■	20
A201100404353	KU 0404.03	NDW 100 QU V115	4	4	3 x 50		②	③											■	20
A2011006063530001	KU 0606.03	NDW 100 QU V115	6	6	3 x 30		②	③											■	20
A201100606353	KU 0606.03	NDW 100 QU V115	6	6	3 x 50		②	③											■	20
A2011008083530001	KU 0808.03	NDW 100 QU V115	8	8	3 x 30		②	③											■	20
A201100808353	KU 0808.03	NDW 100 QU V115	8	8	3 x 50		②	③											■	20

Shape KU, Spherical (according to DIN 69170)



Grinding, Polishing  
(bonded)

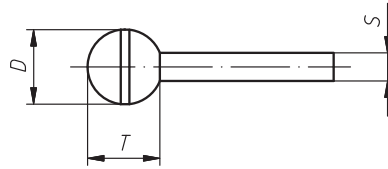

Ordering example: A201100606302

Further dimensions, qualities and shank lengths on request.

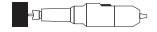

PG 3

Product number	Description	Quality	D mm	T mm	S mm	recommended for Information on page 438			
A201100606302	KU 0606.03	EKR 60 N V4	6	6	3 x 30	① ② ③			■ 20
A2011006063020001	KU 0606.03	EKR 80/100 QU V4	6	6	3 x 30	① ② ③			■ 20
A201100606312	KU 0606.03	EKWBR. 60 O/P V7	6	6	3 x 30	① ②			■ 20
A201100606602	KU 0606.06	EKR 60 N V4	6	6	6 x 40	① ② ③			■ 20
A201100606612	KU 0606.06	EKWBR. 60 O/P V7	6	6	6 x 40	① ②			■ 20
A201100808302	KU 0808.03	EKR 60 N V4	8	8	3 x 30	① ② ③			■ 20
A201100808312	KU 0808.03	EKWBR. 60 O/P V7	8	8	3 x 30	① ②			■ 20
A201100808602	KU 0808.06	EKR 60 N V4	8	8	6 x 40	① ② ③			■ 20
A2011008086020001	KU 0808.06	EKR 60/80 QU V4	8	8	6 x 40	① ② ③			■ 20
A201101010302	KU 1010.03	EKR 60 N V4	10	10	3 x 30	① ② ③			■ 20
A201101010312	KU 1010.03	EKWBR. 60 O/P V7	10	10	3 x 30	① ②			■ 20
A201101010347	KU 1010.03	RKD 80 P V21	10	10	3 x 30	② ③ ④			■ 20
A201101010602	KU 1010.06	EKR 60 N V4	10	10	6 x 40	① ② ③			■ 20
A201101313302	KU 1313.03	EKR 46 N V4	13	13	3 x 30	① ② ③			■ 20
A201101313602	KU 1313.06	EKR 46 N V4	13	13	6 x 40	① ② ③			■ 20
A2011013136020001	KU 1313.06	EKR 46 QU V4	13	13	6 x 40	① ② ③			■ 20
A201101616602	KU 1616.06	EKR 46 N V4	16	16	6 x 40	① ② ③			■ 20
A201101616647	KU 1616.06	RKD 60 P (6) V21	16	16	6 x 40	② ③ ④			■ 20
A201102020602	KU 2020.06	EKR 36 N V4	20	20	6 x 40	① ② ③			■ 20
A2011020206020001	KU 2020.06	EKR 60 P V21	20	20	6 x 40	① ② ③			■ 20
A201102020612	KU 2020.06	EKWBR. 46 O/P V7	20	20	6 x 40	① ②			■ 20
A201102525602	KU 2525.06	EKR 36 N V4	25	25	6 x 40	① ② ③			■ 20
A201102525627	KU 2525.06	NK 24 N BA. soft	25	25	6 x 40	② ③ ④ ⑥			■ 20
A201102525647	KU 2525.06	RKD 30 QU V21	25	25	6 x 40	② ③ ④			■ 20
A201902525626	KU 2525.06	HOK 0-3 V9	25	25	6 x 40			⑧	■ 20
A201103232602	KU 3232.06	EKR 30 N V4	32	32	6 x 40	① ② ③			■ 20
A201903838626	KU 3838.06	HOK 0-3 V9	38	38	6 x 40			⑧	■ 20

## Shape TO, Cup (according to DIN 69170)

★★☆☆

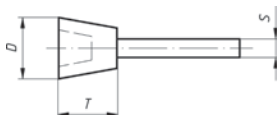

Ordering example: A202002019602

Further dimensions, qualities and shank lengths on request.



Grinding, Polishing (bonded)



PG 3

Product number	Description	Quality	D mm	T mm	S mm	recommended for Information on page 438		
A202002019602	TO 2020.06	EKR 60 N V4	20	20	6 x 40	① ② ③	■	20
A202002524602	TO 2524.06	EKR 60 N V4	25	24	6 x 40	① ② ③	■	20
A202003229602	TO 3229.06	EKR 60 N V4	32	29	6 x 40	① ② ③	■	20
A202004036602	TO 4036.06	EKR 60 N V4	40	36	6 x 40	① ② ③	■	20

## Shape KE, Conical round nose (according to DIN 69170)

★★☆☆

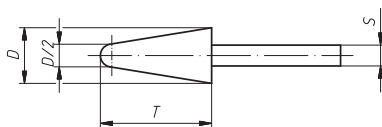

Ordering example: A201501025677



PG 3

Product number	Description	Quality	D mm	T mm	S mm	recommended for Information on page 438		
A201501025677	KE 1025.06	CERAMIC 46 LV118	10	25	6 x 40	② ③ ④ ⑦	■	20
A201501632677	KE 1632.06	CERAMIC 46 L V118	16	32	6 x 40	② ③ ④ ⑦	■	20

Shape KE, Conical round nose (according to DIN 69170)



Ordering example: A201501632618A

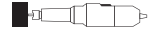

Grinding, Polishing  
(bonded)

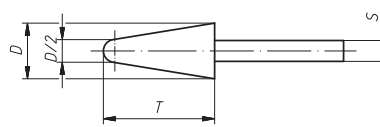

PG 3

Product number	Description	Quality	D mm	T mm	S mm	recommended for Information on page 438		
A201501632618A	KE 1632.06	SIC-ALU 80 V27 W	16	32	6 x 40	6	■	20
A201502040618A	KE 2040.06	SIC-ALU 80 V27 W	20	40	6 x 40	6	■	20

Shape KE, Conical round nose (according to DIN 69170)



Ordering example: A201501025647

Further dimensions, qualities and shank lengths on request.

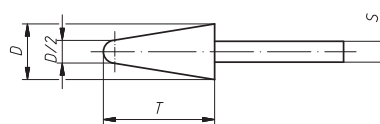

PG 3

Product number	Description	Quality	D mm	T mm	S mm	recommended for Information on page 438		
A201501025647	KE 1025.06	RKD 60 P (6) V21	10	25	6 x 40	② ③ ④	■	20
A201601025606	KE 1025.06	EKRBR.46/60 P V7	10	25	6 x 40	①	■	20
A201501632602	KE 1632.06	EKR 46 N V4	16	32	6 x 40	① ② ③	■	20
A201501632616	KE 1632.06	MK 36 N V10	16	32	6 x 40	② ④ ⑤	■	20
A201501640602	KE 1640.06	EKR 46 N V4	16	40	6 x 40	① ② ③	■	20
A2015016456470002	KE 1645.06	RKD 46 O V13	16	45	6 x 40	② ③ ④	■	20
A201601645606	KE 1645.06	EKRBR.46/60 P V7	16	45	6 x 40	①	■	20
A201502032602	KE 2032.06	EKR 36 N V4	20	32	6 x 40	① ② ③	■	20
A201502032616	KE 2032.06	MK 36 N V10	20	32	6 x 40	② ④ ⑤	■	20
A201502040602	KE 2040.06	EKR 36 N V4	20	40	6 x 40	① ② ③	■	20
A201502040616	KE 2040.06	MK 36 N V10	20	40	6 x 40	② ④ ⑤	■	20
A201502040647	KE 2040.06	RKD 36 O (6) V21	20	40	6 x 40	② ③ ④	■	20
A201502570602	KE 2570.06	EKR 36 N V4	25	70	6 x 40	① ② ③	■	20
A201503250647	KE 3250.06	RKD 30 O (6) V21	32	50	6 x 40	② ③ ④	■	20
A201503250833	KE 3250.08	HK 30 N V13	32	50	8 x 40	④ ⑤	■	20

Shape A, American shapes



Ordering example: A206200620602

Further dimensions, qualities and shank lengths on request.

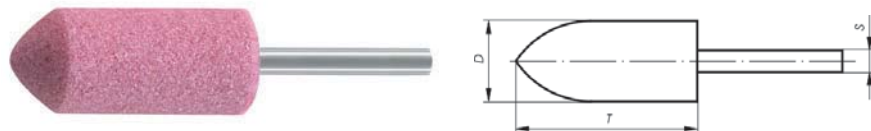

Grinding, Polishing (bonded)



PG 3

Product number	Description	Shape	Quality	D inch	T inch	D mm	T mm	S mm	recommended for	Information on page 438			
A2062022636020001	A1 2263.06		EKR 36 N V4	7/8	2 1/2	22	63	6 x 40	① ② ③		■	20	
A206202263633	A1 2263.06		HK 36/46 M V13	7/8	2 1/2	22	63	6 x 40		④ ⑤	■	20	
A206202532602	A2 2532.06		EKR 36 QU V4	1	1 1/4	25	32	6 x 40	① ② ③		■	20	
A206201645633	AS-3 1645.06		HK 36/46 M V13	5/8	1 3/4	16	45	6 x 40		④ ⑤	■	20	
A2062025706020001	A3 2570.06		EKR 36 N V4	1	2 3/4	25	70	6 x 40	① ② ③		■	20	
A206202570633	A3 2570.06		HK 36/46 M V13	1	2 3/4	25	70	6 x 40		④ ⑤	■	20	
A206402570833	A3 2570.08		HK 36/46 M V13	1	2 3/4	25	70	8 x 40		④ ⑤	■	20	
A206203232602	A4 3232.06		EKR 30/36 QU (7) V21	1 1/4	1 1/4	32	32	6 x 40	① ② ③		■	20	
A206202250602	A11 2250.06		EKR 36 QU V4	7/8	2	22	50	6 x 40	① ② ③		■	20	
A2062022506020001	A11 2250.06		EKR 36 N V4	7/8	2	22	50	6 x 40	① ② ③		■	20	
A206202250633	A11 2250.06		HK 36/46 M V13	7/8	2	22	50	6 x 40		④ ⑤	■	20	
A206202250626	A11 2250.06		HOK 0-3 V9	7/8	2	22	50	6 x 40			⑧	■	20
A206402250833	A11 2250.08		HK 36/46 M V13	7/8	2	22	50	8 x 40		④ ⑤	■	20	
A206201832602	A12 1832.06		EKR 30/36 QU (7) V21	1	1 1/4	18	32	6 x 40	① ② ③		■	20	
A206200625602	A15 0625.06		EKR 80/100 QU V4	1/4	1	6	25	6 x 40	① ② ③		■	20	
A206200625633	A15 0625.06		HK 46/60 N V13	1/4	1	6	25	6 x 40		④ ⑤	■	20	
A206200620602	A24 0620.06		EKR 60/80 QU V4	1/4	3/4	6	20	6 x 40	① ② ③		■	20	
A206204010602	A36 4010.06		EKR 60/80 QU V4	1 5/8	3/8	40	10	6 x 40	① ② ③		■	20	
A206204010608	A36 4010.06		EKW 60 L (2) V13	1 5/8	3/8	40	10	6 x 40		③	⑦ ⑨	■	20
A206203206602	A37 3206.06		EKR 46 QU V4	1 1/4	1/4	32	6	6 x 40	① ② ③		■	20	

Shape B, American shapes

★★☆

Grinding, Polishing  
(bonded)

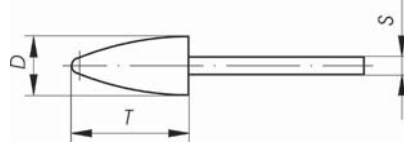

Ordering example: A206600816302

Further dimensions, qualities and shank lengths on request.

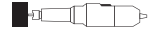

PG 3

Product number	Description	Shape	Quality	D inch	T inch	D mm	T mm	S mm	recommended for information on page 438		
A206601616302	B41 1616.03		EKR 60/80 QU V4	5/8	5/8	16	16	3 x 30	① ② ③		■ 20
A206601020302	B52 1020.03		EKR 46 QU V4	3/8	3/4	10	20	3 x 30	① ② ③		■ 20
A206600816302	B53 0816.03		EKR 60/80 QU V4	5/16	5/8	8	16	3 x 30	① ② ③		■ 20

Miniature mounted points

★★☆

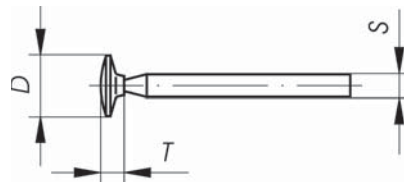

Ordering example: A202900001302

Further dimensions, qualities and shank lengths on request.



PG 3

Product number	Description	Shape	Quality	D mm	T mm	S mm	recommended for Information on page 438		
A202900001302	D1		EKR 100 N V4	9	2	3 x 30	① ② ③		■ 20
A202900001311	D1		EKBR 100 M V1/6	9	2	3 x 30	② ③		■ 20
A202900002302	D2		EKR 80 N V4	9	3	3 x 30	① ② ③		■ 20
A202900002311	D2		EKBR 80 M V1/6	9	3	3 x 30	② ③		■ 20
A202900003302	D3		EKR 100 N V4	8	2	3 x 30	① ② ③		■ 20
A202900003311	D3		EKBR 100 M V1/6	8	2	3 x 30	② ③		■ 20
A202900004302	D4		EKR 100 N V4	4	1	3 x 30	① ② ③		■ 20
A202900004311	D4		EKBR 100 M V1/6	4	1	3 x 30	② ③		■ 20
A202900005302	D5		EKR 80 N V4	5	3	3 x 30	① ② ③		■ 20
A202900005311	D5		EKBR 80 M V1/6	5	3	3 x 30	② ③		■ 20
A202900006302	D6		EKR 80 N V4	7/4	6	3 x 30	① ② ③		■ 20





Miniature mounted points



Grinding, Polishing  
(bonded)

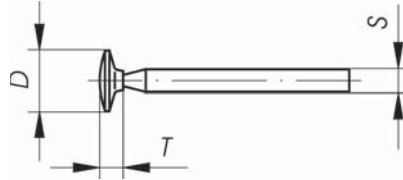

Ordering example: A202900001302

Further dimensions, qualities and shank lengths on request.



PG 3

Product number	Description	Shape	Quality	D mm	T mm	S mm	recommended for Information on page 438		
A202900026302	D26		EKR 100 N V4	6	2,5	3 x 30	① ② ③	■	20
A202900026311	D26		EKBR 100 M V1/6	6	2,5	3 x 30	② ③	■	20
A202900027302	D27		EKR 100 N V4	2/3,5	10	3 x 30	① ② ③	■	20
A202900028302	D28		EKR 80 N V4	3,5/5,5	11	3 x 30	① ② ③	■	20
A202900029302	D29		EKR 100 N V4	3	6,4	3 x 30	① ② ③	■	20
A202900029311	D29		EKBR 100 M V1/6	3	6,4	3 x 30	② ③	■	20
A202900030302	D30		EKR 100 N V4	4,4	10	3 x 30	① ② ③	■	20
A202900030311	D30		EKBR 100 M V1/6	4,4	10	3 x 30	② ③	■	20
A202900032302	D32		EKR 100 N V4	5	7	3 x 30	① ② ③	■	20
A202900032311	D32		EKBR 100 M V1/6	5	7	3 x 30	② ③	■	20
A202900033302	D33		EKR 80 N V4	6	8	3 x 30	① ② ③	■	20
A202900033311	D33		EKBR 80 M V1/6	6	8	3 x 30	② ③	■	20
A202900034302	D34		EKR 100 N V4	4,37	7	3 x 30	① ② ③	■	20
A202900034311	D34		EKBR 100 M V1/6	4,37	7	3 x 30	② ③	■	20
A202900035302	D35		EKR 80 N V4	6	10	3 x 30	① ② ③	■	20
A202900035311	D35		EKBR 80 M V1/6	6	10	3 x 30	② ③	■	20
A202900036302	D36		EKR 80 N V4	6	11	3 x 30	① ② ③	■	20
A202900036311	D36		EKBR 80 M V1/6	6	11	3 x 30	② ③	■	20