

Shape ZY, Cylindrical (according to DIN 69170)

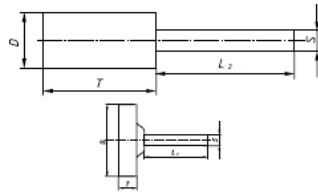

Ordering example: A2610004083080

Further dimensions and grit sizes on request

V<sub>max</sub>: 16 m/s



Grinding, Polishing (bonded)



PG 3

Product number	Description	Grit	Type	D mm	T mm	S mm	L <sub>2</sub> mm	recommended for Information on page 438		
A2610008103080	P2ZY 0810.03	80	1	8	10	3	30	1 2 3 4 5 6 7 8	■	20
A2610008103120	P2ZY 0810.03	120	1	8	10	3	30	1 2 3 4 5 6 7 8	■	20
A2610008103220	P2ZY 0810.03	220	1	8	10	3	30	1 2 3 4 5 6 7 8	■	20
A2610008103280	P2ZY 0810.03	280	1	8	10	3	30	1 2 3 4 5 6 7 8	■	20
A2610008166080	P2ZY 0816.06	80	1	8	16	6	30	1 2 3 4 5 6 7 8	■	10
A2610008166120	P2ZY 0816.06	120	1	8	16	6	30	1 2 3 4 5 6 7 8	■	10
A2610008166220	P2ZY 0816.06	220	1	8	16	6	30	1 2 3 4 5 6 7 8	■	10
A2610008166280	P2ZY 0816.06	280	1	8	16	6	30	1 2 3 4 5 6 7 8	■	10
A2610010103046	P2ZY 1010.03	46	1	10	10	3	30	1 2 3 4 5 6 7 8	■	20
A2610010103080	P2ZY 1010.03	80	1	10	10	3	30	1 2 3 4 5 6 7 8	■	20
A2610010103120	P2ZY 1010.03	120	1	10	10	3	30	1 2 3 4 5 6 7 8	■	20
A2610010103220	P2ZY 1010.03	220	1	10	10	3	30	1 2 3 4 5 6 7 8	■	20
A2610010103280	P2ZY 1010.03	280	1	10	10	3	30	1 2 3 4 5 6 7 8	■	20
A2610010206080	P2ZY 1020.06	80	1	10	20	6	40	1 2 3 4 5 6 7 8	■	10
A2610010206120	P2ZY 1020.06	120	1	10	20	6	40	1 2 3 4 5 6 7 8	■	10
A2610010206220	P2ZY 1020.06	220	1	10	20	6	40	1 2 3 4 5 6 7 8	■	10
A2610010206280	P2ZY 1020.06	280	1	10	20	6	40	1 2 3 4 5 6 7 8	■	10
A2610013133080	P2ZY 1313.03	80	1	13	13	3	40	1 2 3 4 5 6 7 8	■	20
A2610013133120	P2ZY 1313.03	120	1	13	13	3	40	1 2 3 4 5 6 7 8	■	20
A2610013133220	P2ZY 1313.03	220	1	13	13	3	40	1 2 3 4 5 6 7 8	■	20
A2610013133280	P2ZY 1313.03	280	1	13	13	3	40	1 2 3 4 5 6 7 8	■	20
A2610013163120	P2ZY 1316.03	120	1	13	16	3	40	1 2 3 4 5 6 7 8	■	20
A2610013206046	P2ZY 1320.06	46	1	13	20	6	40	1 2 3 4 5 6 7 8	■	10
A2610013206080	P2ZY 1320.06	80	1	13	20	6	40	1 2 3 4 5 6 7 8	■	10
A2610013206120	P2ZY 1320.06	120	1	13	20	6	40	1 2 3 4 5 6 7 8	■	10
A2610013206220	P2ZY 1320.06	220	1	13	20	6	40	1 2 3 4 5 6 7 8	■	10
A2610013206280	P2ZY 1320.06	280	1	13	20	6	40	1 2 3 4 5 6 7 8	■	10
A2610016163120	P2ZY 1616.03	120	1	16	16	3	40	1 2 3 4 5 6 7 8	■	20
A2610016206080	P2ZY 1620.06	80	1	16	20	6	40	1 2 3 4 5 6 7 8	■	10