

Shape F, Arch round nose

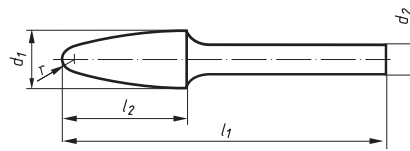

Ordering example: A10100307303

Further dimensions, cuts and shank lengths on request

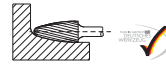
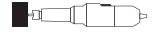

PG 1

Product number	Description	Cut	similar to DIN 8033	d <sub>1</sub> mm	l <sub>2</sub> mm	d <sub>2</sub> mm	l <sub>1</sub> mm	recommended for Information on page 438		
A10100307303	HFF 0307.03	Z3	RBF 0307	3	7	3	40	① ② ③ ④	⑦	■ 1
A10100307304	HFF 0307.03	Z4	RBF 0307	3	7	3	40	② ③ ④	⑦ ⑧	■ 1
A10100307305	HFF 0307.03	Z5	RBF 0307	3	7	3	40	① ② ③ ④	⑦	■ 1
A10100313305	HFF 0313.03	Z5	RBF 0313	3	13	3	40	① ② ③ ④	⑦	■ 1
A10100313308	HFF 0313.03	Z7 Steel	RBF 0313	3	13	3	40	① ② ③	⑤ ⑦	■ 1
A10100313309	HFF 0313.03	Z9 Alu	RBF 0313	3	13	3	40		⑥ ⑧	■ 1
A10100613305	HFF 0613.03	Z5	RBF 0613	6	13	3	43	① ② ③ ④	⑦	■ 1
A10100613308	HFF 0613.03	Z7 Steel	RBF 0613	6	13	3	43	① ② ③	⑤ ⑦	■ 1
A10100618603	HFF 0618.06	Z3	RBF 0618	6	18	6	50	① ② ③ ④	⑦	■ 1
A10100618604	HFF 0618.06	Z4	RBF 0618	6	18	6	50	② ③ ④	⑦ ⑧	■ 1
A10100618605	HFF 0618.06	Z5	RBF 0618	6	18	6	50	① ② ③ ④	⑦	■ 1
A10100618608	HFF 0618.06	Z7 Steel	RBF 0618	6	18	6	50	① ② ③	⑤ ⑦	■ 1
A10100618609	HFF 0618.06	Z9 Alu	RBF 0618	6	18	6	50		⑥ ⑧	■ 1
A10100618620	HFF 0618.06	Z42 Inox/Steel	RBF 0618	6	18	6	50	① ② ③ ④		■ 1
A10100618621	HFF 0618.06	Cast	RBF 0618	6	18	6	50		⑤	■ 1
A10100820603	HFF 0820.06	Z3	---	8	20	6	60	① ② ③ ④	⑦	■ 1
A10100820608	HFF 0820.06	Z7 Steel	---	8	20	6	60	① ② ③	⑤ ⑦	■ 1
A10100820620	HFF 0820.06	Z42 Inox/Steel	---	8	20	6	60	① ② ③ ④		■ 1
A10100820621	HFF 0820.06	Cast	---	8	20	6	60		⑤	■ 1
A10101020603	HFF 1020.06	Z3	RBF 1020	10	20	6	60	① ② ③ ④	⑦	■ 1
A10101020604	HFF 1020.06	Z4	RBF 1020	10	20	6	60	② ③ ④	⑦ ⑧	■ 1
A10101020606	HFF 1020.06	Z6	RBF 1020	10	20	6	60	② ③ ④	⑦ ⑧	■ 1
A10101020608	HFF 1020.06	Z7 Steel	RBF 1020	10	20	6	60	① ② ③	⑤ ⑦	■ 1
A10101020620	HFF 1020.06	Z42 Inox/Steel	RBF 1020	10	20	6	60	① ② ③ ④		■ 1
A10101020621	HFF 1020.06	Cast	RBF 1020	10	20	6	60		⑤	■ 1
A10101225601	HFF 1225.06	Z1	RBF 1225	12	25	6	65		⑥ ⑧	■ 1
A10101225603	HFF 1225.06	Z3	RBF 1225	12	25	6	65	① ② ③ ④	⑦	■ 1
A10101225604	HFF 1225.06	Z4	RBF 1225	12	25	6	65	② ③ ④	⑦ ⑧	■ 1
A10101225608	HFF 1225.06	Z7 Steel	RBF 1225	12	25	6	65	① ② ③	⑤ ⑦	■ 1
A10101225609	HFF 1225.06	Z9 Alu	RBF 1225	12	25	6	65		⑥ ⑧	■ 1
A10101225620	HFF 1225.06	Z42 Inox/Steel	RBF 1225	12	25	6	65	① ② ③ ④		■ 1
A10101225621	HFF 1225.06	Cast	RBF 1225	12	25	6	65		⑤	■ 1
A10101225803	HFF 1225.08	Z3	RBF 1225	12	25	8	65	① ② ③ ④	⑦	■ 1
A10101225808	HFF 1225.08	Z7 Steel	RBF 1225	12	25	8	65	① ② ③	⑤ ⑦	■ 1
A10101225809	HFF 1225.08	Z9 Alu	RBF 1225	12	25	8	65		⑥ ⑧	■ 1
A10101230603	HFF 1230.06	Z3	RBF 1230	12	30	6	70	① ② ③ ④	⑦	■ 1
A10101230608	HFF 1230.06	Z7 Steel	RBF 1230	12	30	6	70	① ② ③	⑤ ⑦	■ 1

Shape F, Arch round nose



Ordering example: A10100307303

Further dimensions, cuts and shank lengths on request

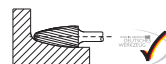
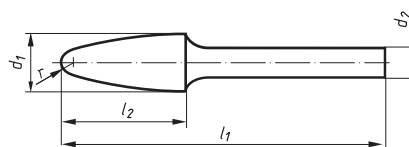

PG 1

Product number	Description	Cut	similar to DIN 8033	d <sub>1</sub> mm	l <sub>2</sub> mm	d <sub>2</sub> mm	l <sub>1</sub> mm	recommended for Information on page 438		
A10101630608	HFF 1630.06	Z7 Steel	RBF 1630	16	30	6	70	① ② ③ ⑤ ⑦	■	1
A10101630609	HFF 1630.06	Z9 Alu	RBF 1630	16	30	6	70	⑥ ⑧	■	1
A10101630803	HFF 1630.08	Z3	RBF 1630	16	30	8	70	① ② ③ ④ ⑦	■	1
A10101630809	HFF 1630.08	Z9 Alu	RBF 1630	16	30	8	70	⑥ ⑧	■	1

Shape F, Arch round nose BASE-X



Ordering example: A10100313322

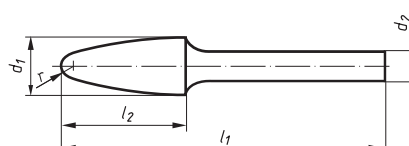

PG 1

Product number	Description	Cut	similar to DIN 8033	d <sub>1</sub> mm	l <sub>2</sub> mm	d <sub>2</sub> mm	l <sub>1</sub> mm	recommended for Information on page 438		
A10100313322	HFF 0313.03 BASE-X	ZX	RBF 0313	3	13	3	40	① ② ③ ④ ⑤ ⑦	■	10
A10100618622	HFF 0618.06 BASE-X	ZX	RBF 0618	6	18	6	50	① ② ③ ④ ⑤ ⑦	■	10
A10100820622	HFF 0820.06 BASE-X	ZX	—	8	20	6	60	① ② ③ ④ ⑤ ⑦	■	10
A10100820622150	HFF 0820.06 BASE-X	ZX	—	8	20	6	170	① ② ③ ④ ⑤ ⑦	■	1
A5010082062214	HFF 0820.06 BASE-X	ZX	—	8	20	1/4"	60	① ② ③ ④ ⑤ ⑦	■	10
A10101020622	HFF 1020.06 BASE-X	ZX	RBF 1020	10	20	6	60	① ② ③ ④ ⑤ ⑦	■	10
A5010102062214	HFF 1020.06 BASE-X	ZX	RBF 1020	10	20	1/4"	60	① ② ③ ④ ⑤ ⑦	■	10
A10101225622	HFF 1225.06 BASE-X	ZX	RBF 1225	12	25	6	65	① ② ③ ④ ⑤ ⑦	■	5
A5010122562214	HFF 1225.06 BASE-X	ZX	RBF 1225	12	25	1/4"	65	① ② ③ ④ ⑤ ⑦	■	5
A10101225622150	HFF 1225.06 BASE-X	ZX	—	12	25	6	175	① ② ③ ④ ⑤ ⑦	■	1